

# Verso CF 1700 U/H/V

Nominal air flow, m <sup>3</sup> /h	1700
Panel thickness, mm	50
Unit weight, kg	243
Supply voltage HE, V	3~400
Supply voltage HW, V	1~230
Maximal operating current HE, A	12,9
Maximal operating current HW, A	6,7
Filters dimensions BxHxL, mm	800x400x46-M5
Electric power input of the fan drive at maximum flow rate, W	465
Electric air heater capacity, kW / Δt, °C	4,5/7,4
Control panel	C5.1
Maintenance space, mm	800



The photo is intended for informational purposes only, exact details may vary.

### Acoustic data

A-weighted sound power level  $L_{WA}$ , dB(A)  
at nominal flow rate

Supply inlet	60
Supply outlet	77
Exhaust inlet	59
Exhaust outlet	77
Casing	59

A-weighted sound pressure level  $L_{PA}$ , dB(A)

10 m<sup>2</sup> normally isolated room, distance from casing – 3 m.

Surroundings	49
--------------	----

### Temperature efficiency

Outside temperature, °C	Winter					Summer		
	-23	-15	-10	-5	0	25	30	35
After heat exchanger, °C	14,7	15,3	16,1	16,8	17,7	22,7	23,9	25,2

indoor +22°C, 10% RH

### Changeover water heating/cooling exchanger (HCW)

Water temperature in/out, °C	Winter			Summer
	80/60	70/50	60/40	7/12
Capacity, kW	4,2	4,2	4,2	11,5
Flow rate, dm <sup>3</sup> /h	184	183	182	1971
Pressure drop, kPa	2,4	2,4	2,4	90,6
Temperature in/out, °C	14,7 / 22			25,2 / 18
Maximal capacity, kW	20,7	16,7	12,6	14,5
Connection, "				½

Available versions:

- 1) Electric air heater (HE)
- 2) Changeover water heating/cooling exchanger (HCW)

### Performance

Supply air filter F7, exhaust air filter M5

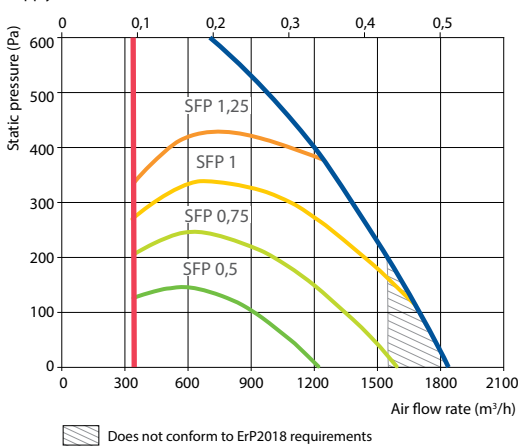

### Shown as right (R1)

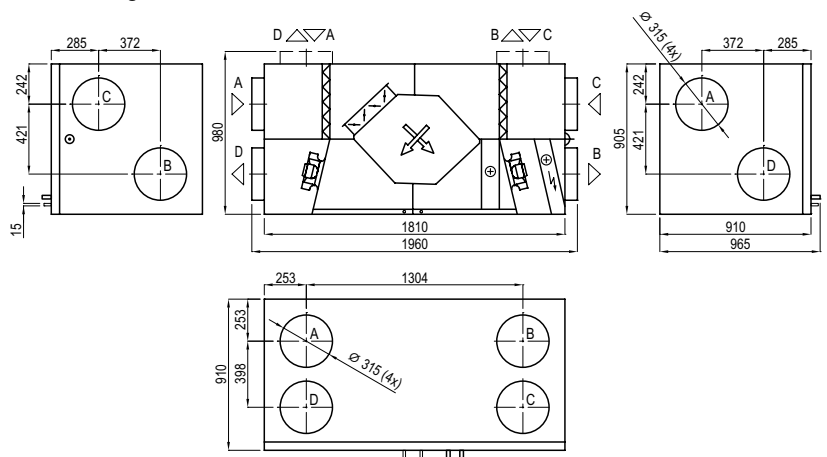

### Shown as left (L1)

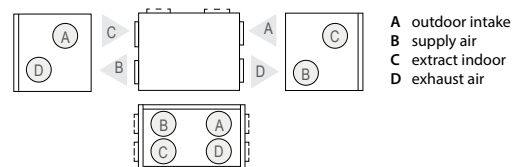

### Accessories (p. 108)

Closing damper	AGUJ-M-315+LF24/LM24
Silencer	A/D AGS-315-100-900-M
	B/C AGS-315-100-1200-M
PPU	PPU-HW-3R-15-1,6-W2
Water cooler	DCW-1,6-11
2-way valve	VVP47.20-4,0+SSP61
DX cooler	DCF-1,6-11
Cooling unit	MOU-36HFN6-KA8243